

K5 Drinking Water Station



Kineticco K5 Drinking Water Station

Owner's Manual



Congratulations for choosing Kinetico to improve the quality of your water. You will immediately begin to notice the numerous benefits of having quality water in your home and the benefits of having a Kinetico water treatment system.

Since 1970, Kinetico Incorporated has designed and manufactured products to improve the quality of your water. Kinetico offers a complete line of quality water systems to solve your water problems. Pioneers in non-electric, demand operated water treatment, Kinetico continually sets the direction for the entire water quality industry.

© 2008 Kinetico Incorporated

"Kineticco," the Kineticco logo, the "QuickFlo Drinking Water, Storage Tank" with logo, "MACguard", "EverClean" and "PureMometer" are trademarks in the United States, other countries or both, of Kinetico Incorporated, Newbury, Ohio. MADE IN U.S.A.

Table of Contents

Using The Kinetico K5 Drinking Water Station	3
How Your K5 Drinking Water Station Works	4
What Makes Your K5 Drinking Water Station Different Is What Makes It Better	7
System Accessories	8
Maintaining Your K5 Drinking Water Station	9
Filter Changes	9
Shutting Off the System	9
Booster Pumps	10
Nitrate/Nitrite Kit	10
Cartridge Changes and Sanitization	11
Replacement Filter Cartridges	13
System Specifications	14
Maintenance Record	15
Version Francaise	unavailable at this time
Version Español	unavailable at this time

Kinetico Incorporated
10845 Kinsman Rd
Newbury, Ohio, 44065
USA
www.kinetico.com

Kinetico Canada Incorporated
16524 Hurontario St.
Caledon, Ontario L0N 1C0
Canada
www.kinetico.com

Kinetico Denmark
ApS
Tigervej 12-14
Køge, DK-4600
Denmark

Kinetico UK Limited
Bridge House
Park Gate Business Centre
Park Gate Hampshire SO31
1FQ
England
www.kinetico.co.uk

Kinetico France Sarl
B.P.54
Parc d'Activités de la demi-Lune
2, rue Gutenberg
95420 Magny en Vexin
France
www.kinetico.fr

Using the Kinetico K5 Drinking Water Station



Water is the most important liquid in the world. And although the water you use for drinking and cooking constitutes less than one percent of all water used in the home, its quality is probably most important to you.

Experts suggest you drink approximately eight, eight-ounce glasses of water per day. Now that you have a Kinetico K5 Drinking Water Station, you can rest assured you're drinking clean, high quality water. And it will taste great too. With a Kinetico K5 Drinking Water Station, drinking those eight glasses of water will be a pleasure, not a chore.

How To Use High Quality Drinking Water

Since Kinetico K5 Drinking Water Stations significantly reduce heavy metals (such as lead), chemicals, minerals, and unpleasant tastes and odors in your water,* you may want to make some adjustments when using Kinetico Drinking Water for cooking.

* The contaminants listed are not necessarily in your water.

1 Let your taste buds decide how much water to use.

When mixing concentrated juices and drinks or making gelatin, tea or coffee, you may need to adjust the amount of water used. You may find that you can use less coffee or tea and still get the desired taste. Or in the case of concentrated drinks, you can add more water without getting a watered-down taste. Also, it probably won't be necessary for you to descale your automatic coffee maker with vinegar as recommended.

2 Kinetico Drinking Water is ideal for cooking and baking.

Don't forget to use water from your Kinetico K5 Drinking Water Station for cooking pasta, and washing fruits and vegetables. Whenever a recipe calls for water, reach for your special drinking water tap.



Kinetico K5 Drinking Water Station

3 *Use Kinetico Drinking Water in irons and small humidifiers/vaporizers.*

For extended operation and easier maintenance, use Kinetico Drinking Water in irons and small humidifiers. You'll no longer have to buy distilled water or suffer the consequences of using common tap water in irons and humidifiers. Since water produced by your system has a reduced mineral content, it's ideal for use in these appliances and it's available right at your kitchen sink.

4 *Make ice cubes with Kinetico Drinking Water.*

If your refrigerator/freezer is equipped with an ice maker, you may want to consider running a line from your system to the ice maker. If you don't have an ice maker, be sure to fill your ice cube trays with Kinetico Drinking Water. Either way, you'll be able to enjoy better tasting and clearer ice cubes.

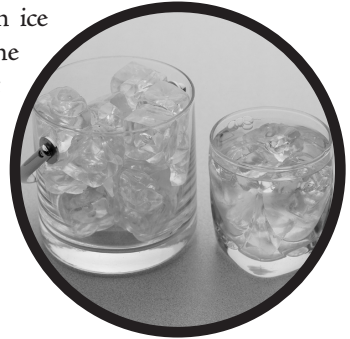

5 *Houseplants and pets like Kinetico Drinking Water too.*

Don't forget about your plants and pets. Just like you, they'll love Kinetico Drinking Water.

How Your Drinking Water Station Works

The Kinetico K5 Drinking Water Station offers exclusive seven-stage protection to ensure you're always getting good, clean water. The K5 Drinking Water Station reduces the heavy metals, chemicals, minerals, and objectionable tastes and odors that may be in your water. We even offer a cartridge that adds valuable minerals to your treated drinking water.

Stage 1 – Prefilter

The first filtration stage prepares the water for the reverse osmosis process. The five-micron filter captures sediment and small particulate matter, and reduces chlorine protecting the reverse osmosis membrane and enhancing its performance.

Replacement Cartridges:

Sediment Prefilter – Part number 9309A

Carbon and Sediment Prefilter – Part number 9461A

Stage 2 – Reverse Osmosis Membrane

After prefiltration, the water travels to the reverse osmosis membrane where the primary cleaning is performed. Here, water is forced through a semi permeable membrane under pressure, and most minerals, chemicals or objectionable matter that might have been in your water are flushed down the drain.

Replacement Cartridges:

Reverse Osmosis Membrane – Part number 12752

Stage 3 – Auxiliary Filter #1

The next two stages allow you the flexibility to meet your needs, by offering you a variety of cartridges.

Purefecta Bacteria/Virus Guard – is certified to remove more than 99.99% virus and 99.99999% of bacteria. When used with the VOC guard and an air charge tank, the system is a certified microbiological purifier. The Purefecta Bacteria/Virus Guard can only be used in the auxiliary #1 position.

VOC Guard – removes volatile organic compounds. See performance datasheet for a list of contaminants.

Arsenic Guard – by working with the RO membrane, the Arsenic Guard is able to remove both Trivalent Arsenic and Pentavalent Arsenic. See performance datasheet for more information on the two forms of arsenic.

Perchlorate Guard – removes perchlorate, a by-product from rocket and jet fuel, found in various locations around the world.

Mineral Plus – this exciting new innovation adds beneficial minerals, such as magnesium and calcium, to your drinking water. This cartridge will also enhance the taste of your treated water.

Replacement Cartridges:

Purefecta Bacteria/Virus Guard – Part number 12873

VOC Guard – Part number 9307A

Arsenic Guard – Part number 11781

Perchlorate Guard – Part number 11682

Mineral Plus – Part number 13041

Kinetico K5 Drinking Water Station

Stage 4 – Auxiliary Filter #2

Replacement Cartridges:

VOC Guard – Part number 9307A

Arsenic Guard – Part number 11781

Perchlorate Guard – Part number 11682

Mineral Plus – Part number 13041

Stage 5 – Storage Tank

After the water is processed through the first four stages, it is stored in a tank until needed. Unlike all other storage tanks available, the “water on water” tank with QuickFlo technology uses your home’s water pressure to deliver Kinetico Water from your storage tank to your drinking water faucet. Since the storage tank uses your home’s water pressure rather than a pressurized air charge, you’ll have a steady, consistent flow of water from your tap, even if your storage tank is almost empty.

Stage 6 – Postfilter Polisher

After leaving the storage tank, the water travels to the next stage of protection, the MACguard® Filter. Containing activated carbon, the MACguard Filter gives a final polish to your water, further reducing unpleasant tastes and odors.

Replacement Cartridges:

Taste and Odor Filter – Part number 9306B

Stage 7 – Faucet

The final protection stage is a custom, decorator, lead-free tap, which is mounted on your sink. With this tap, you can be sure that lead won’t be added back into your drinking water.

What Makes Your Drinking Water System Different is What Makes It Better

Like other Kinetico equipment, the Kinetico K5 Drinking Water Station is non-electric and demand operated. With demand operation, Kinetico systems produce high quality drinking water, while they maximize water efficiency and performance.

EverClean® Rinse

After shutdown, the system initiates the EverClean Rinse feature, which is patented and exclusive to Kinetico. The membrane's surface is automatically cleansed with and left to bathe in clean, processed water. This extends the useful life of the membrane, enables it to maintain a high level of performance and prevents inorganic contaminants from migrating into the treated water during shutoff.

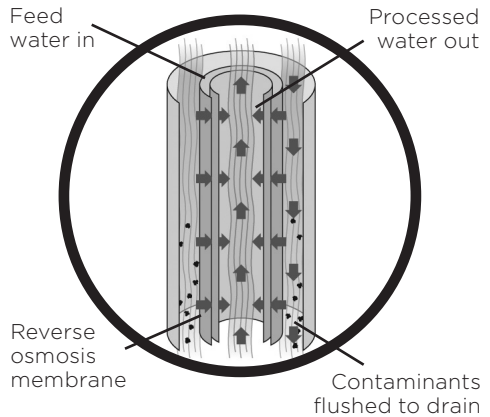

MACguard Filter

One of the system's most unique features is the automatic shutoff of the MACguard Filter. ("MAC" stands for Metered Automatic Cartridge.) After 500 gal (1895 L) of water have been processed through the MACguard Filter, it shuts off (no flow or fine stream) to alert you that the filter is exhausted. The filter cannot be reset, and no more water can be drawn from the system. This signals the need to change the prefilter and postfilter cartridges, but more importantly, it prevents you from using the cartridges beyond their capacity. If overused, cartridges lose their filtration ability.

PureMometer® Filter Life Indicator

Your system is equipped with the PureMometer (rhymes with thermometer) Filter Life Indicator so you can tell how much capacity remains in your filter cartridges. Use the PureMometer to estimate when to purchase replacement prefilter and postfilter cartridges so you won't be surprised when the failsafe MACguard Filter shuts down the system.

System Accessories

Your system may also include the following upgrades, which are available from your local Kinetico dealer.

Decorator Finish, Lead-Free Taps

Choose from highly stylish decorator taps to complement your decor. Available in Classic Chrome (standard), Brilliant Nickel, Satin Nickel/Stainless, Antique Bronze/Copper, Polished Brass, Light Biscuit, Arctic White and Black Licorice.

Performance Monitor

Kinetico's Performance Monitor measures the level of TDS (total dissolved solids) in your product water every time you draw a glass. A green light indicates your system is rejecting the proper amount of dissolved solids. A yellow light indicates it is not and you should contact your local, authorized Kinetico dealer. If the monitor does not light when you draw water, you may need to replace the batteries in the control module mounted under your sink.



Oversized Storage Tank

A larger storage tank supplies more water on demand for larger families. There's no need to do anything special to your system. Simply enjoy your clean, clear Kinetico Water.

Maintaining Your Drinking Water System

The Kinetico K5 Drinking Water Station is engineered to take the guesswork out of quality water. It will tell you when routine maintenance needs to be performed to keep your drinking water system working properly.

Filter Changes

If you open your tap and don't get any water, or only get a small stream, it could mean one of two things: your storage tank is out of water and the drinking water system is making more, or your MACguard Filter has shut off. Check your system's PureMometer to see if the MACguard Filter has shut off. Periodically checking the PureMometer could alert you of upcoming filter shutdown before it happens. If the MACguard Filter has not shut off, wait an hour or two and try to draw water from the faucet again.

How long a MACguard Filter cartridge will last depends on your drinking water usage. It could last anywhere from a few months to a few years. An average family of four with average drinking water use can expect the cartridge to last approximately nine months to one year. Kinetico recommends annual cartridge replacements even if your system has not shut off.

When your MACguard Filter does shut off, we recommend you call your local, authorized Kinetico dealer. They will change your cartridges, completely sanitize your system, check your water and make sure your system is operating properly. If you choose to install your new cartridges yourself, follow the instructions carefully. Never attempt to remove the prefilter or postfilter cartridges without first depressurizing the system. Be sure to completely sanitize your system by following the instructions provided in the "Sanitization Procedure" section of this owner's manual to prevent contamination from human contact.

Kinetico K5 Drinking Water Station

Shutting Off the System

If you should ever discover a problem with your drinking water system, turn off the water supply to the system. Then call your local, authorized Kinetico dealer for service.

NOTE: The Kinetico K5 Drinking Water Station's operational, maintenance and replacement instructions must be followed to ensure proper system performance. The reverse osmosis system contains a replaceable component critical to the efficiency of the system. Any replacement reverse osmosis component must be identical to the one listed here to assure the same efficiency and contaminant reduction performance. Recommended hardness is zero to 10 gpg for extended product life. Do not use where water is microbiologically unsafe or with water of unknown quality. Systems claiming cyst reduction may be used on disinfected water containing filterable cysts. If you plan to be away from home for more than a few days, shut off the water supply to your system to extend its life. You may also want to drain the drinking water storage tank upon your return to ensure the freshest water.

Booster Pumps

Some households require booster pumps to ensure that adequate feed pressure is being supplied to the system. Unplug or turn off the power supply to any pumps before attempting to service your system.

Nitrate/Nitrite Kit

If you purchased your system specifically for nitrate reduction, Kinetico recommends periodic (quarterly) testing with a nitrate/nitrite test kit (Part No. 7329) to assure that nitrate/nitrites are being reduced to acceptable levels.

Cartridge Changes and Sanitization

If you choose to change the cartridges on your Kinetico K5 Drinking Water Station yourself, you must use a sanitization kit available from your Kinetico dealer. Follow these instructions to fully sanitize your system. Wash your hands thoroughly and do not touch any internal portions of the system. Or call your local, authorized Kinetico dealer who can change the necessary filters, disinfect your system and analyze your water to be sure it is of the best quality.

NOTE: Although great care is taken to provide a sanitized drinking water unit, possible contamination can result from vendor products, assembly, packaging, shipping or extended storage time. Proper sanitization is required.

IMPORTANT: do not drink water from system during sanitization.

WARNING: *To avoid possible injury and property damage, this system must be properly depressurized before attempting to remove any cartridge or other component.*

WARNING: *After completing the sanitization procedure, the tank must be filled and drained twice before water can be consumed.*

Sanitization Procedure for K5 WOW Cartridge Change

Kinetico K5 Drinking Water Station

1

Close feed

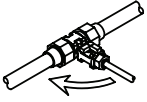

2

Open faucet to depressurize system

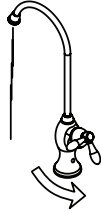

3

Attach anti-spray line and close faucet

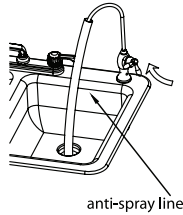

4

Remove postfilter and install cartridge plug

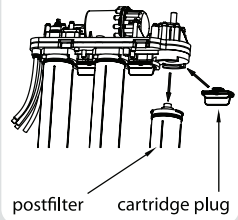

5

Open feed

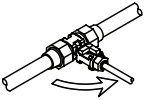

6

Open faucet to empty permeate from storage tank

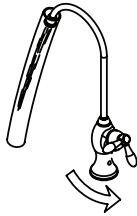

7

Close feed

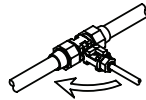

8

Wait 3 minutes

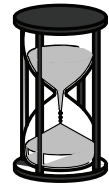

9

Close faucet

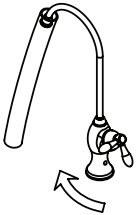

10

Turn jack screw down

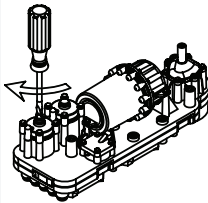

11

Remove all remaining cartridges

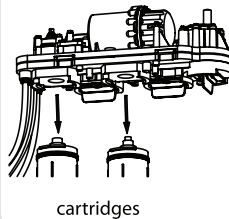

12

Install cartridge plugs in all locations

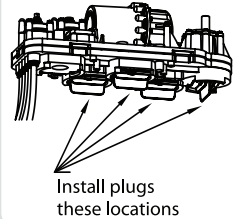

13

- Pour one package of cleaning agent into dry cartridge plug
- Install plug into cartridge prefilter position

cleaning agent

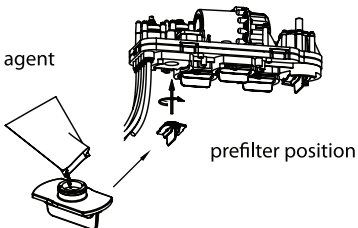

14

- Disconnect drive line from yellow port on manifold
- Place line into a 5 gallon bucket
- Install 3/8 inch plug into yellow port

drive line

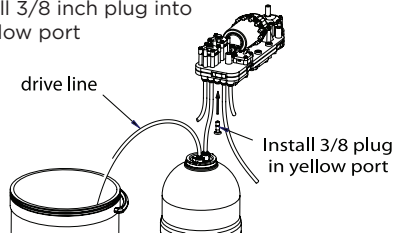

15

Slowly open feed valve

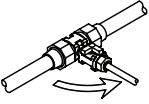

16

Wait 4 minutes



17

Close feed

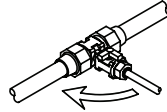

18

Discard water in bucket



19

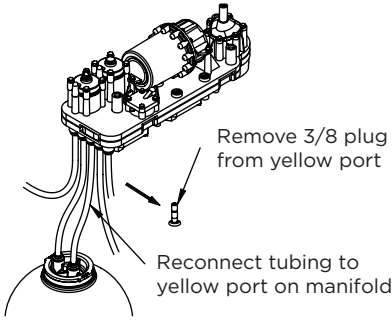

20

Slowly crack open faucet to depressurize the system

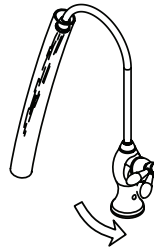

WARNING: Do not open faucet all the way. Air, water and chemical solution will spray out forcefully. Be prepared to control the anti-spray line.

21

Allow system to depressurize. Close faucet

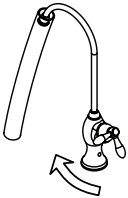

22

Pour one package into center of pre-filter cartridge and install

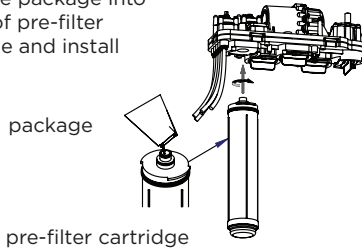

23

Install RO and post-filter

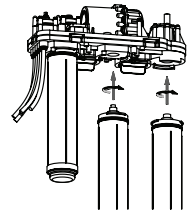

24

Slowly open feed valve

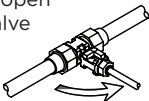

26

Open jack screw all the way up

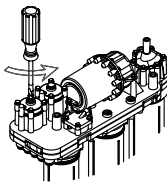

27

Open faucet - watch out for spray

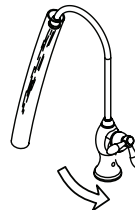

28

Wait for flow to drop off, close faucet, remove anti-spray line

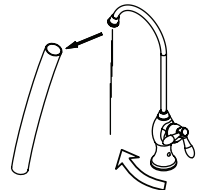

25

Wait 2 minutes



29

Allow tank to fill for 1 1/2 hours then discard 2 tanks of water.

Sanitization Procedure for K5 Air Charge Cartridge Change

Kinetico K5 Drinking Water Station

1

Close feed

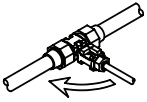

2

Close tank valve

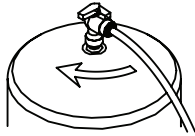

3

Open faucet to depressurize system

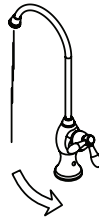

4

Close faucet

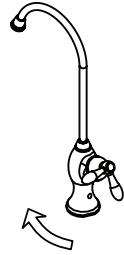

5

Remove postfilter and install cartridge plug

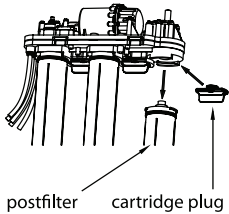

postfilter cartridge plug

6

Open tank ball valve

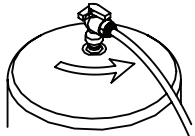

7

Open faucet to empty permeate from storage tank

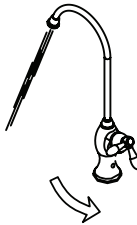

8

Close faucet

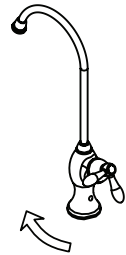

9

attach anti-spray line

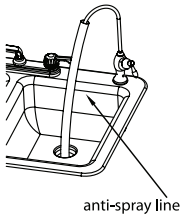

anti-spray line

10

Remove all remaining cartridges and install plugs

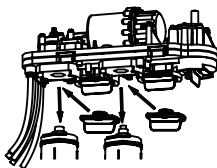

11

- Pour one package of cleaning agent into dry cartridge plug
- Install plug into cartridge prefilter position

cleaning agent

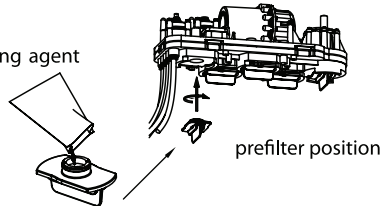

prefilter position

12

Slowly open feed valve

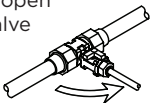

14

Close feed

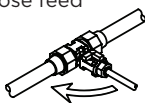

16

Slowly crack open faucet to depressurize the system

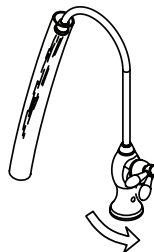

WARNING: Do not open faucet all the way. Air, water and chemical solution will spray out forcefully. Be prepared to control the anti-spray line.

13

Wait 4 minutes



15

Close tank valve



14

- may hear a buzzing, this is OK

17

Leave faucet open

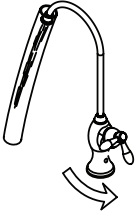

18

Pour one package into center of pre-filter cartridge and install

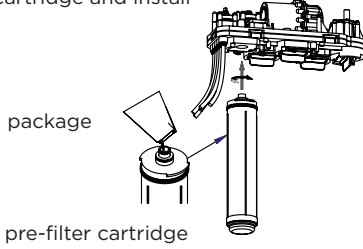

19

Install RO and post-filter

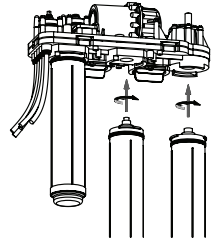

20

Remove 3/8" plug from yellow port on manifold and insert 3/8" tube into same yellow port.

Place the other end into a 5 gallon bucket.

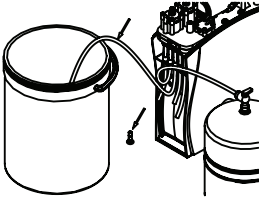

21

Slowly open feed valve

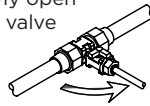

23

Open jack screw all the way up

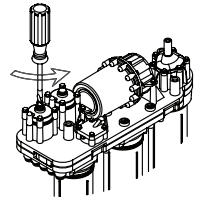

22

Wait 2 minutes



24

Fill bucket



WARNING:
Do not overflow

25

Close feed

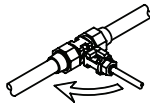

26

Close jack screw

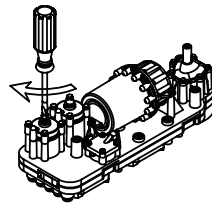

27

Remove 3/8" line and replace plug in yellow port

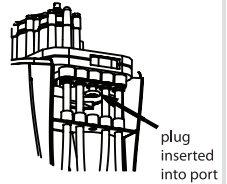

28

Discard water in bucket



29

Close faucet



30

Open tank ball valve



31

Open faucet - watch out for spray



32

Wait for flow to stop



33

Close faucet



34

Remove anti-spray line



35

Slowly open feed valve

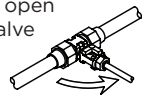

36

Inform customer to allow tank to fill for several hours then discard 1-2 tanks of water.

Kinetico K5 Drinking Water Station

Replacement Filter Cartridges

To ensure optimum performance, continued warranty coverage and that your system continues to comply with NSF certification standards, you must replace the prefilter and postfilter cartridges annually or upon system shutoff, whichever occurs first. Use the following chart to determine which filters are appropriate for your system.

Location	Cartridge Part Number
MACguard Postfilter (A)	Taste and Odor Postfilter - 9306B
Auxiliary #2 (B)	VOC Guard - Part number 9307A Arsenic Guard - Part number 11781 Perchlorate Guard - Part number 11682 Mineral Plus - Part number 13041
RO Membrane (C)	Part number 12752
Auxiliary #1 (D)	Purefecta Bacteria/Virus Guard -Part number 12873 VOC Guard - Part number 9307A Arsenic Guard - Part number 11781 Perchlorate Guard - Part number 11682 Mineral Plus - Part number 13041
Prefilter (E)	Sediment Prefilter (non -chlorinated feed) - Part number 9309A Carbon/Sediment Prefilter (chlorinated feed) - Part number 9461A



System Specifications

TDS maximum level	3000 ppm
pH Range:	3-11
Pressure Ranges:	35-120 psi (2.41-8.27 bar), 40 psi (2.76 bar) minimum for Nitrate reduction
Temperature Range	35° -100° F (2° -38° C)
Water Supply	0-10 grains per gallon hardness, 0 - 0.1 iron
Rated Filter Capacity (Auxiliary and Postfilter)	500 gallons (1895 L)
Maximum Daily Production Rate	75gpd* (283 Lpd)
Membrane Discharge	1 to 1
Water/Product Water Ratio:	
Discharge Water/Product Water Ratio:	2.8 to 1.0
Typical Product Water Production Rate:	40.6 gpd (153.7 Lpd)
Efficiency Rating ¹	24.4%
Recovery Rating ²	39.9%



The Kineticco K5 Drinking Water Station is tested and certified by NSF International against the requirements of NSF/ANSI Standard 42 for the reduction of aesthetic chlorine, taste and odor and Standard 58 for the reduction of pentavalent arsenic, barium, radium 226/228, cadmium, copper, cysts (including oocysts of cryptosporidium and cysts of giardia and entamoeba), fluoride, hexavalent chromium, lead, nitrate/nitrite (with test kit Part No. 7329), selenium, TDS (commonly comprised of calcium, magnesium, sodium, iron, manganese, bicarbonate, sulfate and carbonate), trivalent chromium and turbidity.

(See performance data sheet for individual contaminants and reduction performance.)

Do not use with water that is microbiologically unsafe or of unknown quality without adequate disinfection before or after the system. Systems certified for cyst reduction may be used on disinfected water that may contain filterable cysts.

The Kineticco K5 Drinking Water Station is acceptable for treatment of influent concentrations of no more than 27 mg/L nitrate and 3 mg/L nitrite in combination measured as N and are certified for nitrate/nitrite reduction only for water supplies with a pressure of 280 kPa (40 psi) or greater.

NSF International certify our product performance, and review our manufacturing facility and procedures to assure product consistency and integrity. They also assure that our literature accurately reflects our product capabilities.

The system and installation must comply with state/provincial and local laws and regulations.

U.S. Patent numbers 4,698,164; ,629,568; 4,650,586
Canadian Patent number 1,323,310

Maintenance Record

Kinetico Drinking Water Model: _____

Prefilter Type: _____

MACguard Postfilter Type: _____

Date	Prefilter Changed	Postfilter Changed	Membrane Changed	TDS of Treated Water	Sanitized

