

CE152T/S/208



FEATURES

- Two elements, three zones accommodate different pan sizes

- High-frequency pulsation technology for superior performance and control

- True simmer setting for soups, sauces and more

- Super-low Melt setting for fine chocolate and other delicate foods

- Rigorously tested in our U.S. manufacturing facilities for decades of use

- Exceptional 24/7 support from our Customer Care team in Madison

- Illuminated touch controls

- Hot surface indicator lights when temperature exceeds 150°F

- Temperature limiter ensures that safe operating temps are never exceeded

- Universal "off" turns all elements off

- Control panel lock for safety

- Automatic timer up to 99 minutes

- Ceran ceramic glass resists scratching, staining, impact and heat



TOP CONFIGURATION

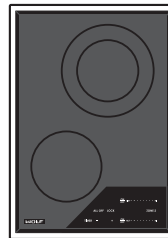

COOKTOP SPECIFICATIONS

- 1-5 1/2" Single Element (1200W)
- 1-8" Dual Element (700/2200W)

PRODUCT SPECIFICATIONS

Model	CE152T/S/208
Dimensions	15"W x 3 1/2"H x 21"D
Weight	30 lb
Electrical Supply	3-wire, 208 VAC, 60 Hz
Electrical Service	20 amp dedicated circuit
Conduit Length	4 feet

ELECTRICAL

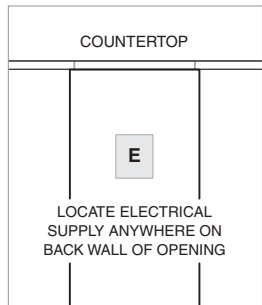

DIMENSIONS

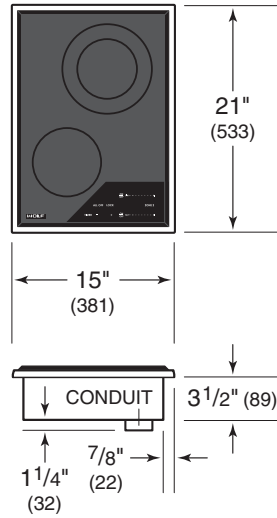

STANDARD INSTALLATION

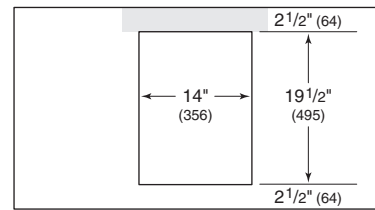

COUNTERTOP CUT-OUT

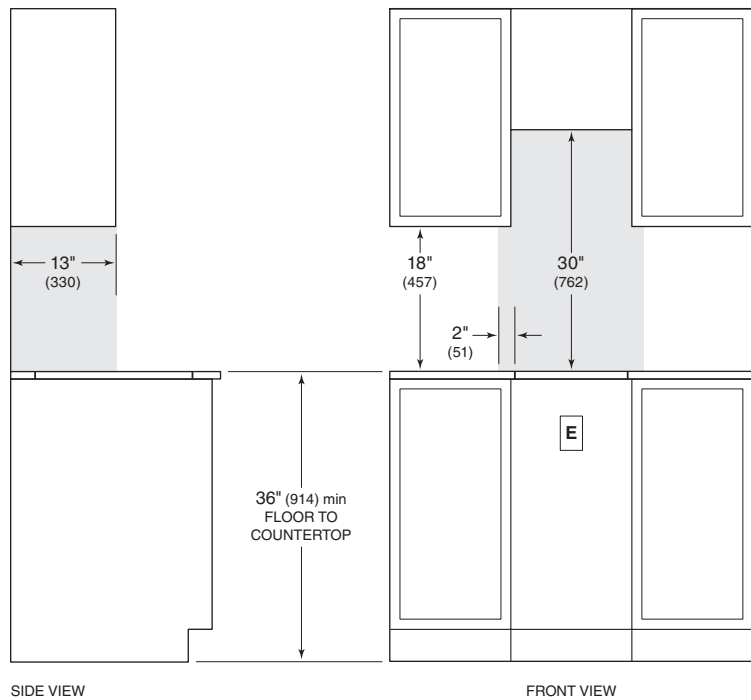

SIDE VIEW

FRONT VIEW

NOTE: Shaded area above countertop indicates minimum clearance to combustible surfaces, combustible materials cannot be located within this area.