



MEASURING THE DELIVERY PATH

STEP 1

Measure the height and width of the exterior entrance doorway. The entranceway needs to be a minimum of 1" larger than either the width or depth of the refrigerator.

STEP 2

Measure the height and width of the pathway leading to the kitchen. Make sure to take into account factors such as doors, hallways, tight turns and rounded archways.

If the fridge is being delivered to a second floor, measure the width of the staircase, taking into consideration the railing as well as corners.

Please note most refrigerator doors and some home doors can be removed. Once you have measured the delivery path, please inform your Trail Appliances sales representative if any doors need to be removed. Additional fees may apply.



MEASURING YOUR KITCHEN

Measure the opening where your fridge will go.

Width* (inches)	Height (inches)	Depth (inches)

* Measure the width between the cabinets, but also the width between the countertops (if applicable) as some countertops slightly overhang the cabinets.

OTHER CONSIDERATIONS

1. Kitchen Island - If there is an island in front of the fridge location, first measure the distance between the front of the cabinets and the island to ensure there is room for the fridge to be delivered. Secondly, measure the distance between the back wall and the island to ensure that the fridge doors will be able to fully open.
2. Fixed Walls - if you are installing your refrigerator next to a fixed wall that is deeper than the refrigerator, you will require additional space to allow the fridge door to open. If applicable, please inform your Trail Appliances sales representative to determine the amount of extra space required.

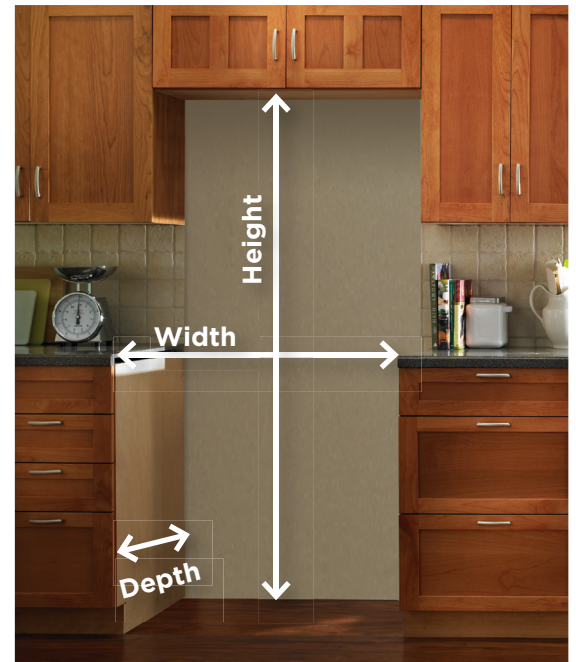

MEASURING YOUR NEW FRIDGE

Measure the overall width, height, and depth of your new fridge

Width (inches)	Height to top of hinge cap (inches)	Depth (inches)

Many fridges have increased capacity by increasing the depth. Be sure to measure how far the fridge will protrude past your cabinets, as this will likely be more than your previous model.

OTHER CONSIDERATIONS

1. If the model you are looking at has an ice-maker and/or water dispenser you will require a water line. Please note Trail Appliances does not disconnect or connect water lines.
2. Please note some fridges do not have a reversible door swing. Please let your Trail Appliances Sale Representative know which side you need your refrigerator to open. (if applicable)

